

RELIEF VALVES AND ANCHORAGE EQUIPMENT DRAINS TO BE IN COMPLIANCE WITH LOCAL CODES AND ANY SEISMIC REQUIREMENTS.

RELIEF VALVES AND EQUIPMENT DRAINS TO BE PIPED TO DRAIN OR VENT BY CONTRACTOR PER CODE REQUIREMENT

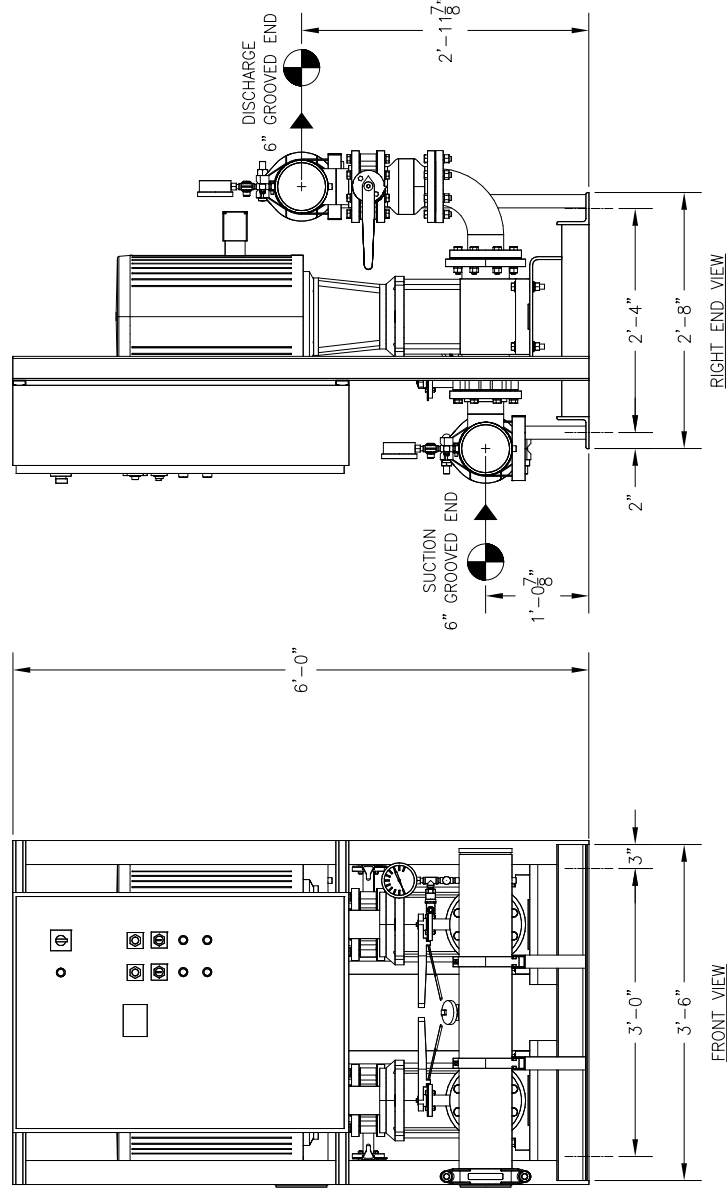
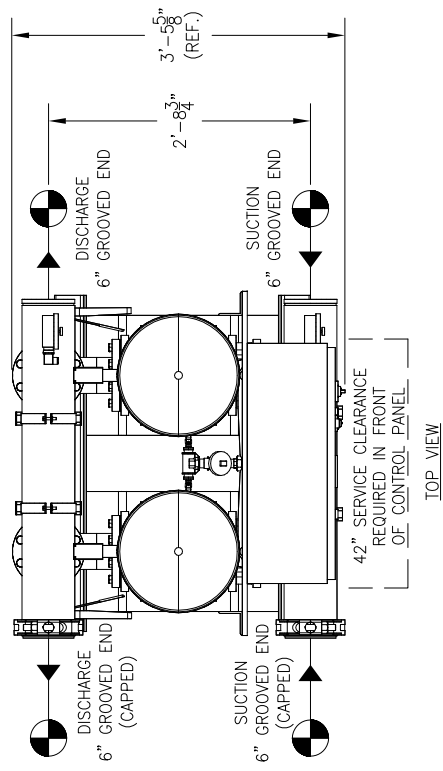
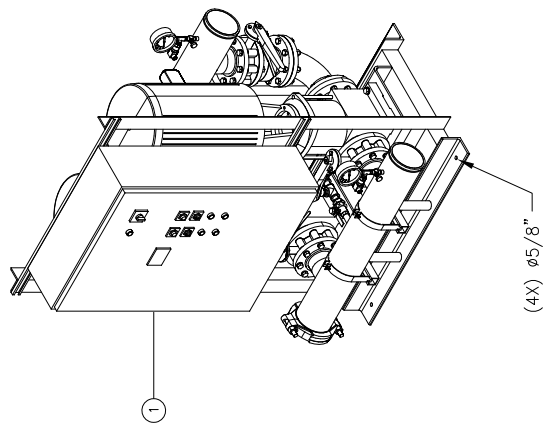
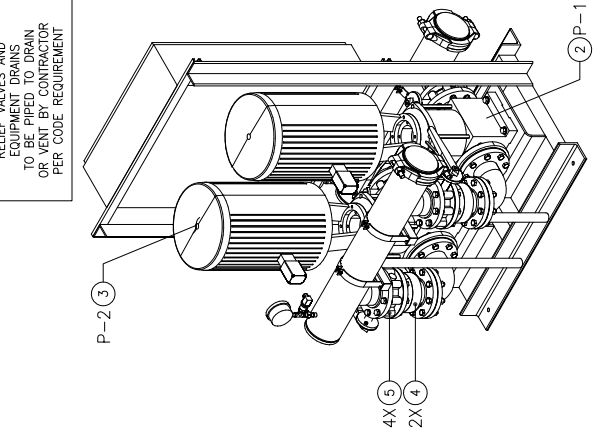

CONSTRUCTION NOTES:
 1. SUCTION AND DISCHARGE HEADERS ARE GROOVED ON BOTH ENDS.
 2. END CAPS CAN BE PLACED ON EITHER END OF HEADERS.
 3. SYSTEM DESIGNED FOR INDOOR INSTALLATION.

TOTAL FLOW		- PSI		- PSI		AVAILABLE PRESSURE	
		TOTAL DISCHARGE PRESSURE		TOTAL SYSTEM CAPACITY			
3	P-2	GOULDS	ESV 66SVG-2	-	25	3500	460 / 60 / 3
2	P-1	GOULDS	ESV 66SVG-2	-	25	3500	460 / 60 / 3
ITEM	TAG	MANUFACTURER	SERIES	MODEL	GPM	TDH	HP
PUMP SCHEDULE							
10	-	-	-	-	-	-	-
9	-	-	-	-	-	-	-
8	-	-	-	-	-	-	-
7	-	-	-	-	-	-	-
6	-	-	-	-	-	-	-
5	4	-	-	-	-	-	-
4	2	-	-	-	-	-	-
3	1	P-2	GOULDS	ESV MULTISTAGE PUMP MODEL 66SVG-2	-	-	-
2	1	P-1	GOULDS	ESV MULTISTAGE PUMP MODEL 66SVG-2	-	-	-
1	1	-	-	AQUALOGIC XL CONTROL PANEL	-	-	-
ITEM	QTY	TAG	DESCRIPTION		EQUIPMENT SCHEDULE		

GENERAL NOTES:
 (1) SINGLE POINT POWER CONNECTION AT CONTROL PANEL.
 (2) HYDRO PRESSURE CHECK AT 125 PSI.
 (3) ASSEMBLED SYSTEM TO BE PAINTED WITH INDUSTRIAL MACHINE ENAMEL PRIOR TO SHIPMENT.

UL LISTED
 PACKAGED PUMPING SYSTEMS & HEAT TRANSFER SYSTEMS

APPROXIMATE SHIPPING WEIGHT: 2,407 LBS.
 APPROXIMATE OPERATING WEIGHT: 2,554 LBS.

PROJECT NAME: _____
 CUSTOMER: _____
 DRAWN BY DATE: _____
 ACD 04/03/18

CHECKED BY APPROVED BY: _____
 TOLERANCES UNLESS OTHERWISE SPECIFIED

DEC. .500" FRACTION 1/2" ANGLE 5" SCALE 1" = 1'-0"

DRAWING NO. FMW2.1-19-XL
 FAB NO. _____
 DRAWING TITLE: FMW2.1-19-XL - VARIABLE SPEED DUPLEX PRESSURE BOOSTER

FlowTherm systems
 HAYWARD, CALIFORNIA

REVISIONS:
 REV 1