

RELIEF VALVES AND ANCHORAGE TO BE IN COMPLIANCE WITH LOCAL CODES AND ANY SEISMIC REQUIREMENTS.

RELIEF VALVES AND EQUIPMENT DRAINS TO BE PIPIED TO DRAIN OR VENT BY CONTRACTOR PER CODE REQUIREMENT.

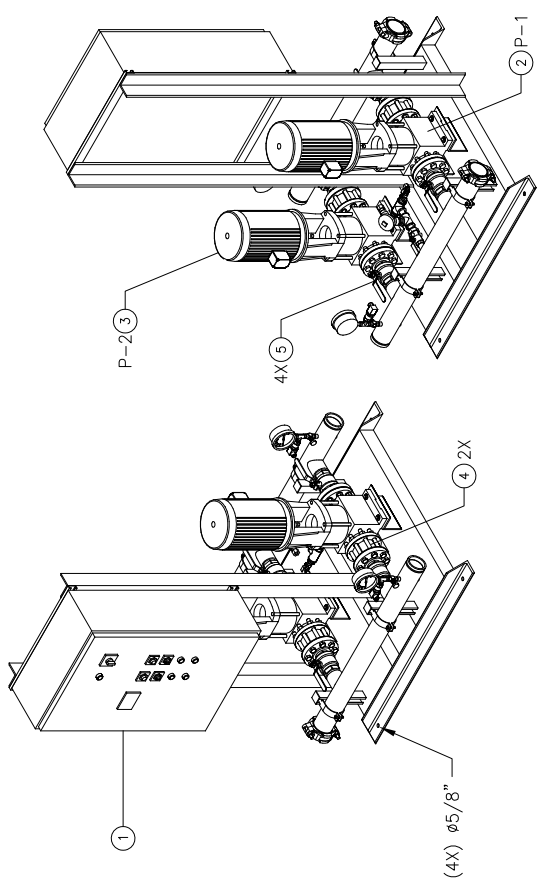

CONSTRUCTION NOTES:
 1. SUCTION AND DISCHARGE HEADERS ARE GROOVED ON BOTH ENDS.
 2. END CAPS CAN BE PLACED ON EITHER END OF HEADERS.
 3. SYSTEM DESIGNED FOR INDOOR INSTALLATION.

TOTAL FLOW		TOTAL DISCHARGE PRESSURE		TOTAL SYSTEM CAPACITY		AVAILABLE PRESSURE	
- GPM		- PSI		- PSI		- PSI	
3	P-2	GOULDS	ESV	15SVG-2	-	5	3500
2	P-1	GOULDS	ESV	15SVG-2	-	5	3500
ITEM	TAG	MANUFACTURER	SERIES	MODEL	GPM	TDH	HP
PUMP SCHEDULE							
10	-	-	-	-	-	-	-
9	-	-	-	-	-	-	-
8	-	-	-	-	-	-	-
7	-	-	-	-	-	-	-
6	-	-	-	-	-	-	-
5	4	-	-	-	-	-	-
4	2	-	-	-	-	-	-
3	1	P-2	GOULDS	ESV MULTI-STAGE PUMP	MODEL 15SVG-2	-	-
2	1	P-1	GOULDS	ESV MULTI-STAGE PUMP	MODEL 15SVG-2	-	-
1	1	-	-	AQUALOGIC XL CONTROL PANEL	-	-	-
ITEM	QTY	TAG	DESCRIPTION				

FlowTherm systems
 HAYWARD, CALIFORNIA

EQUIPMENT SCHEDULE

PROJECT NAME: _____
 CUSTOMER: _____
 DRAWN BY DATE: _____
 ACD 04/19/18

CHECKED BY APPROVED BY: _____

TOLERANCES UNLESS OTHERWISE SPECIFIED

DEC. .500" FRACTION 1/2" ANGLE 5" SCALE 1" = 1'-0"

DRAWING TITLE: FMW2.0-5-XL - VARIABLE SPEED DUPLEX PRESSURE BOOSTER
 FAB NO. _____
 DRAWING NO. FMW2.0-5-XL
 REV 1

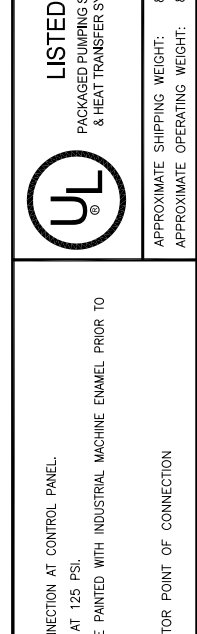
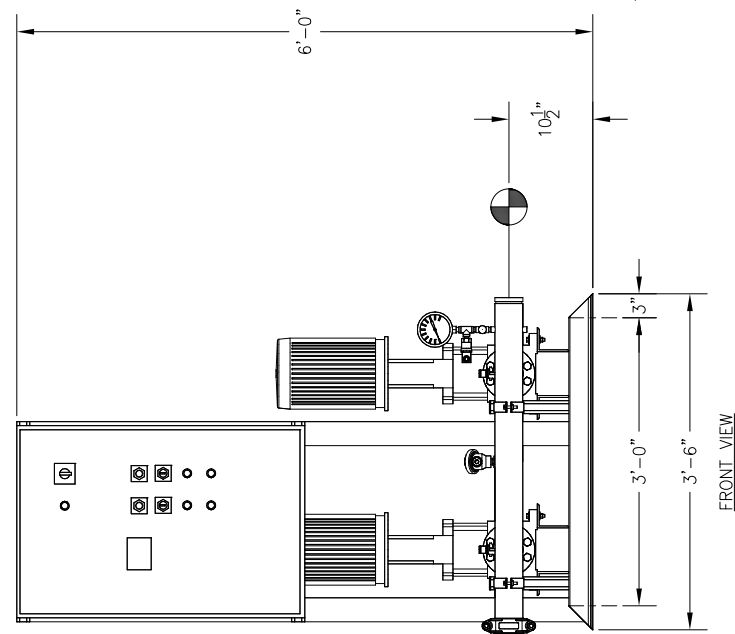
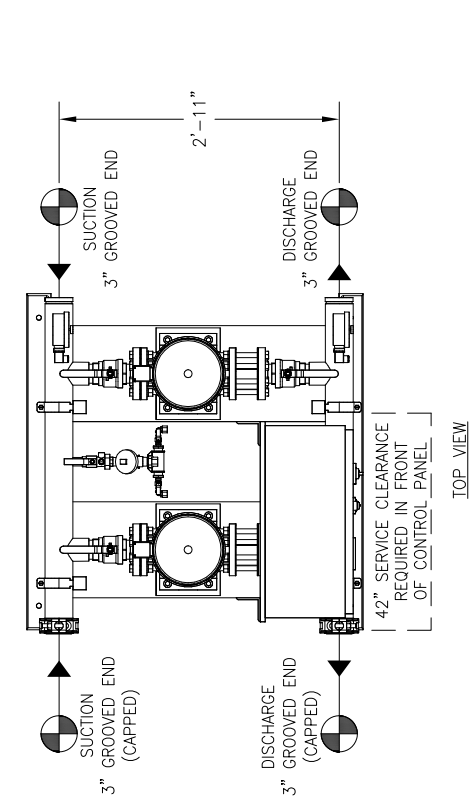

THIS DRAWING AND THE INFORMATION SPECIFIED THEREIN ARE THE PROPERTY OF FLOWTHERM SYSTEMS, A DIVISION OF CHC. COPIES ARE ISSUED IN STRICT CONFIDENCE AND SHALL NOT BE LOANED, REPRODUCED, COPIED, OR USED FOR ANY PURPOSE WITHOUT THE WRITTEN PERMISSION OF CHC.

UL LISTED
 PACKAGED PUMPING SYSTEMS & HEAT TRANSFER SYSTEMS

APPROXIMATE SHIPPING WEIGHT: 809 LBS.
 APPROXIMATE OPERATING WEIGHT: 846 LBS.

GENERAL NOTES:
 (1) SINGLE POINT POWER CONNECTION AT CONTROL PANEL.
 (2) HYDRO PRESSURE CHECK AT 125 PSI.
 (3) ASSEMBLED SYSTEM TO BE PAINTED WITH INDUSTRIAL MACHINE ENAMEL PRIOR TO SHIPMENT.

☉ = DENOTES CONTRACTOR POINT OF CONNECTION