

RELIEF VALVES AND EQUIPMENT DRAINS TO BE PIPED TO DRAIN OR VENT BY CONTRACTOR PER CODE REQUIREMENTS.

ALL BOLTING AND ANCHORAGE TO BE IN COMPLIANCE WITH LOCAL CODES AND ANY SEISMIC REQUIREMENTS.

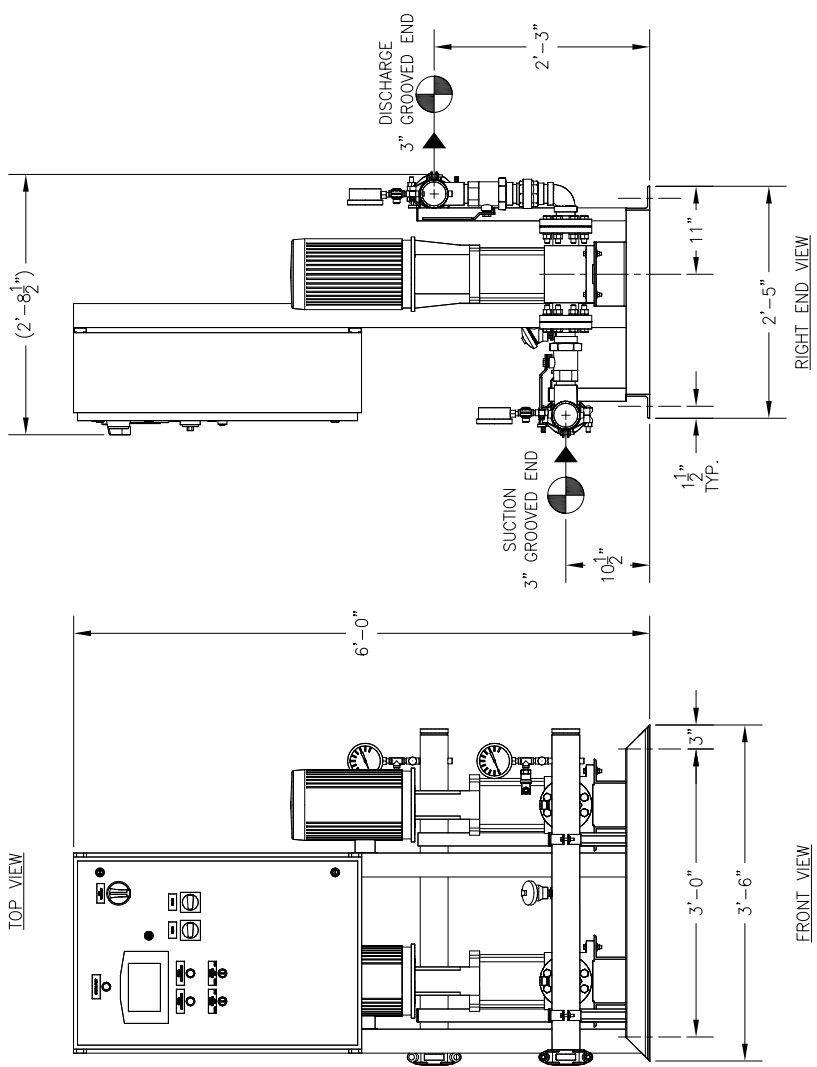
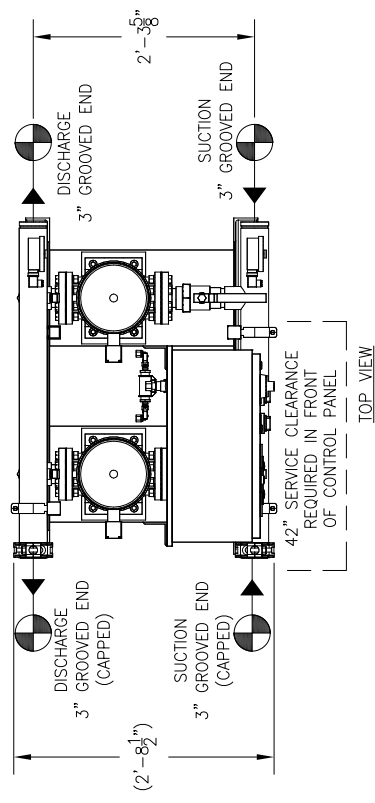
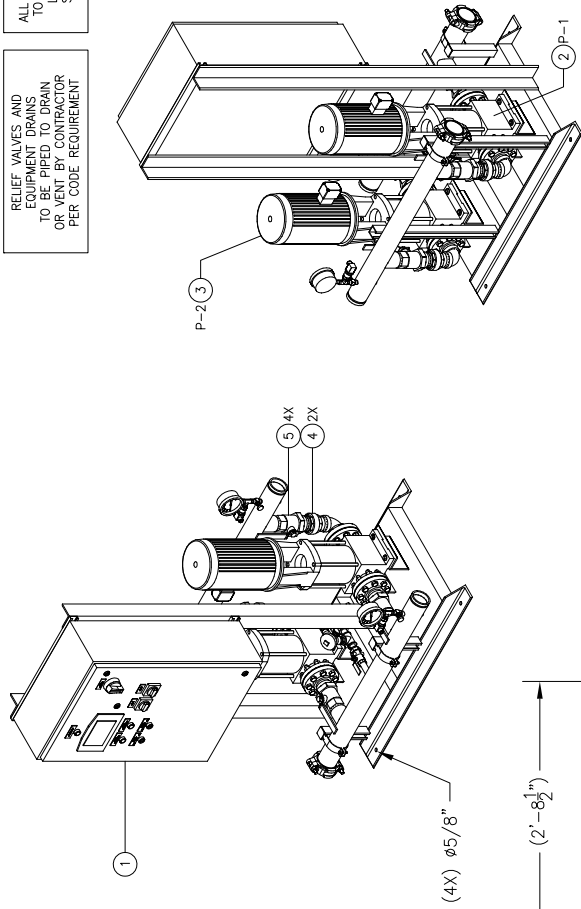

CONSTRUCTION NOTES:  
1. SUCTION AND DISCHARGE HEADERS ARE GROOVED ON BOTH ENDS.  
2. END CAPS CAN BE PLACED ON EITHER END OF HEADERS.  
3. SYSTEM DESIGNED FOR INDOOR INSTALLATION.

TOTAL FLOW		- PSI		- PSI		AVAILABLE PRESSURE									
TOTAL DISCHARGE		PRESSURE		TOTAL SYSTEM CAPACITY											
3	P-2	GOULDS	ESV	15SVG-4	-	-	7 1/2	3500	460	/	60	/	3	TEFC	P.E.
2	P-1	GOULDS	ESV	15SVG-4	-	-	7 1/2	3500	460	/	60	/	3	TEFC	P.E.
ITEM	TAG	MANUFACTURER	SERIES	MODEL	GPM	TDH	HP	RPM	VOLTS/HZ/PH	ENCLOSURE					
PUMP SCHEDULE															
10	-	-	-	-	-	-	-	-	-	-					
9	-	-	-	-	-	-	-	-	-	-					
8	-	-	-	-	-	-	-	-	-	-					
7	-	-	-	-	-	-	-	-	-	-					
6	-	-	-	-	-	-	-	-	-	-					
5	4	-	-	-	-	-	-	-	-	-					
4	2	-	-	-	-	-	-	-	-	-					
3	1	P-2	GOULDS	ESV	MULTI-STAGE	PUMP	MODEL	15SVG-4							
2	1	P-1	GOULDS	ESV	MULTI-STAGE	PUMP	MODEL	15SVG-4							
1	1	-	-	-	-	-	-	-	-	-					
ITEM	QTY	TAG	DESCRIPTION												
EQUIPMENT SCHEDULE															

GENERAL NOTES:

(1) SINGLE POINT POWER CONNECTION AT CONTROL PANEL.

(2) HYDRO PRESSURE CHECK AT 125 PSI.

(3) ASSEMBLED SYSTEM TO BE PAINTED WITH INDUSTRIAL MACHINE ENAMEL PRIOR TO SHIPMENT.

LISTED

PACKAGED PUMPING SYSTEMS & HEAT TRANSFER SYSTEMS

UL

APPROXIMATE SHIPPING WEIGHT: 1,000 LBS.

APPROXIMATE OPERATING WEIGHT: 1,030 LBS.

PROJECT NAME: -

CUSTOMER: -

DRAWN BY DATE: 09/12/19

CHECKED BY: APPROVED BY: ACD

TOLERANCES UNLESS OTHERWISE SPECIFIED

DEC. .500"

FRAC. 1/2"

ANGLE 5"

SCALE 1" = 1'-0"

DRAWING NO. FMW2.1-6-XL

FAB NO. -

DRAWING TITLE: FMW2.1-6-XL - VARIABLE SPEED DUPLEX PRESSURE BOOSTER

REV 1

FlowTherm systems

HAYWARD, CALIFORNIA